

System FC705

Penetration Detail: Structural Steel SHS Column fire-stopped with Protecta EX Mortar

Separating Element: Min. 125mm thick Red Stag CLT Floor

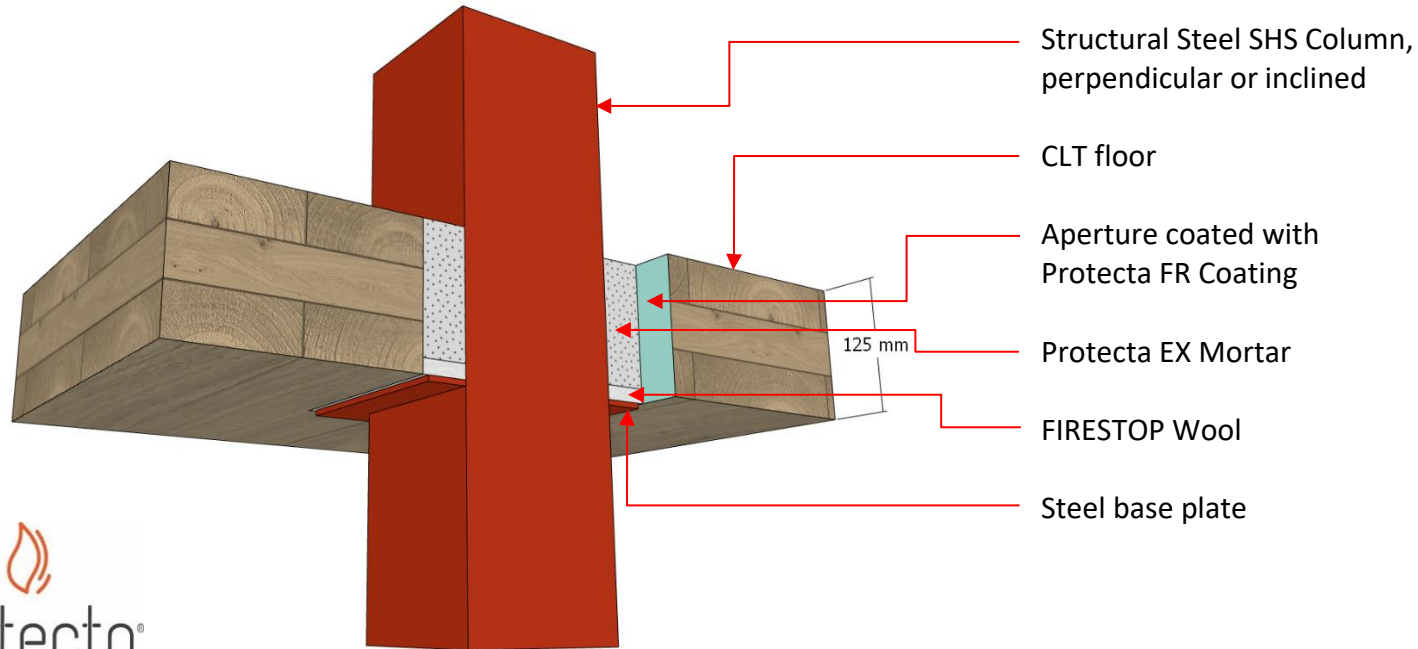

Installation Instructions:

1. Clean all apertures of dust, grease, and debris.
2. Apply one coat of Protecta FR Coating (by brush) to the CLT aperture to prevent contact with Protecta EX Mortar.
3. Install one 13 mm layer of FIRESTOP Wool on the steel plate at the base of the aperture.
4. Apply Protecta EX Mortar:
 - Mix thoroughly to remove lumps at 2:1 ratio.
 - Add mortar to the water - do not reverse.
 - Pour or trowel mortar onto FIRESTOP Wool, filling all corners.
 - Press firmly to remove air bubbles.
 - Build up to full CLT floor depth.

Services & Ratings (FRR)

Column Penetration Details	Orientation	FRR
150mm SHS coated with intumescent paint	90°	-/90/60
Inclined 150mm SHS coated with intumescent paint	60°	-/90/90

Note: The test was conducted with a ceramic fibre blanket (FIRESTOP Wool) wrapped around the column on the underside of the floor to simulate intumescent coating applied to the column.

If the column is not protected with intumescent paint, the tested methodology shall be adopted by installing a ceramic fibre blanket to the column on the underside of the floor. Refer to pages 9, 16, and 18 of the test report.

Compliance

Report TS Fire Lab
Report PF25097
Pages 4 & 16 - 19
Standards AS1530.4-2014 &
AS4072.1-2005

Firestop Centre Technical Support:
Tel: +64 9 483 4000
info@firestopcentre.co.nz
www.firestopcentre.co.nz

Drawing Rev: 1.0

Scale: NTS

Disclaimer: Firestop Centre may change product specifications without notice as part of our ongoing development and testing. All information in this document is provided in good faith and for guidance only. All drawings are for illustration purposes only and may not reflect the actual product. Since we cannot control how the product is installed or the conditions on-site, we do not guarantee the product's performance. We also accept no responsibility for any loss, damage, or injury resulting from the use of this information.